

### 1130 Series

#### Non Handed Door Closer

#### Installation Instructions

80-9311-0011-021 Rev 2

#### Non Hold Open Models

Adjustable  
(Sizes 1 thru 6)

1131



**CAUTION**

An Incorrectly installed or improperly adjusted door closer can cause property damage or personal injury. These installation instructions should be followed to avoid the possibility of misapplication or misadjustment.

**CAUTION**

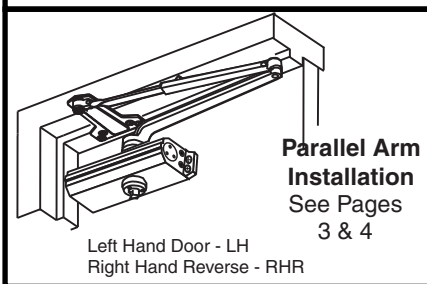
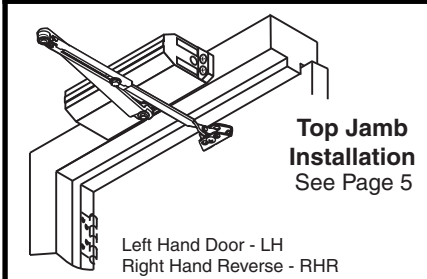
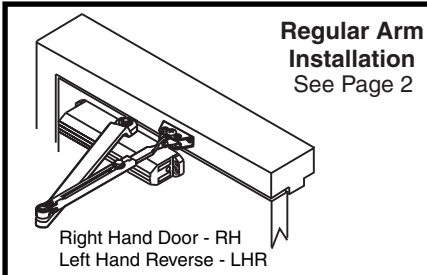

- Doors should be hung on ball bearing or anti-friction hinges.
- A separate door stop is recommended.
- Door and frame must be properly reinforced.
- Adjust closing time speed between 3 and 7 seconds from 90° to 0°.
- These door closers should NOT be installed on the exposed side (weather side) of exterior doors.

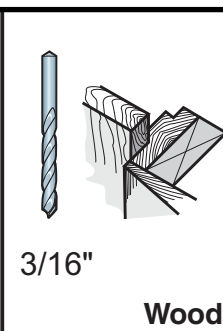
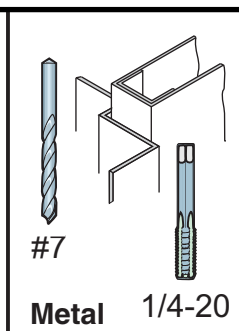
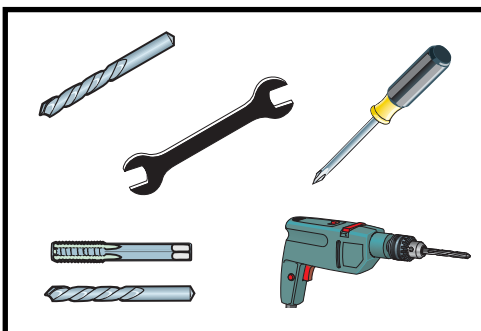
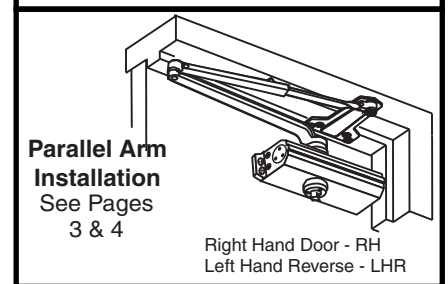
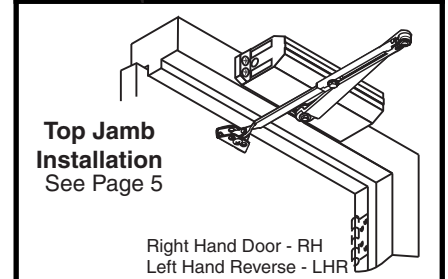
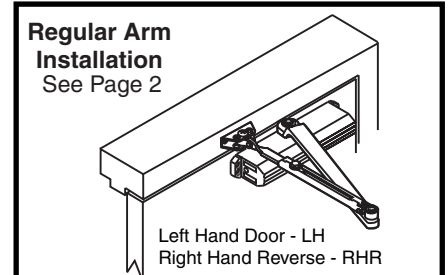

#### Self Drilling Screws Wood and Metal

For Wood drill 3/16 hole

#### Machine Screws

#7 Drill, 1/4-20 Tap

#### (Optional)

#### Sleeve Nut and Bolt

Drill 9/32 thru from Closer Side  
3/8 Drill other side

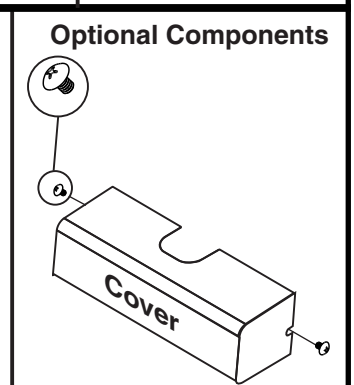
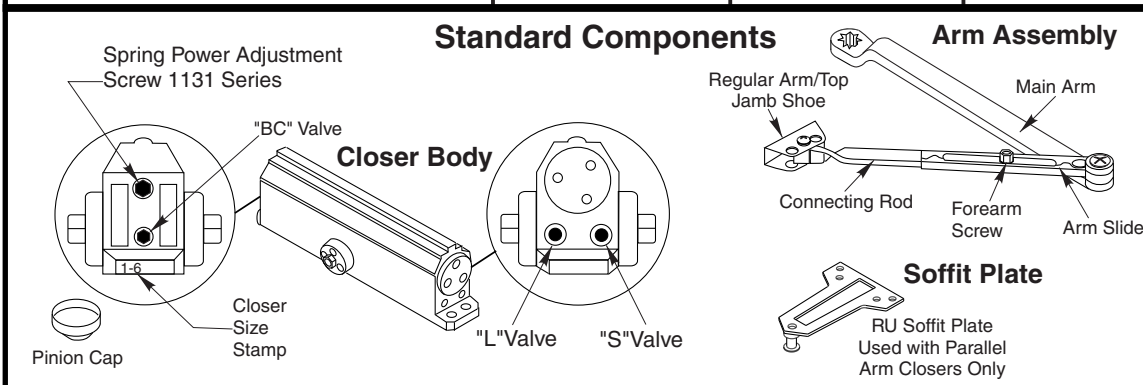

# 1130 Series

## Non Hold Open Door Closers — Regular Arm

80-9311-0011-021 Rev 2

### 1 Parts

Optional Cover

### 3

90° E

Stronger +  
Weaker -

1131 Spring Power Adjust (If Necessary)

### Backcheck

Stronger +  
Weaker -

**Caution:**  
Don't completely close valve

### 2

**Right Hand Shown**

Opening	Dimension "A"	Inches (mm)
To 100°	$\frac{7}{(178)}$	
101° to 120°	$\frac{6}{(152)}$	
* 121° to 180°	$\frac{3-1/2}{(89)}$	

\* Door/Wall/Hardware/Jamb conditions permitting

### 4 Sweep

Slower -  
Faster +

### 5 Latch

Faster +  
Slower -

### 6

### 7 Pinion Cap or Optional Cover

(2)

# 1130 Series

## Non Hold Open Door Closers — Parallel Arm

80-9311-0011-021 Rev 2

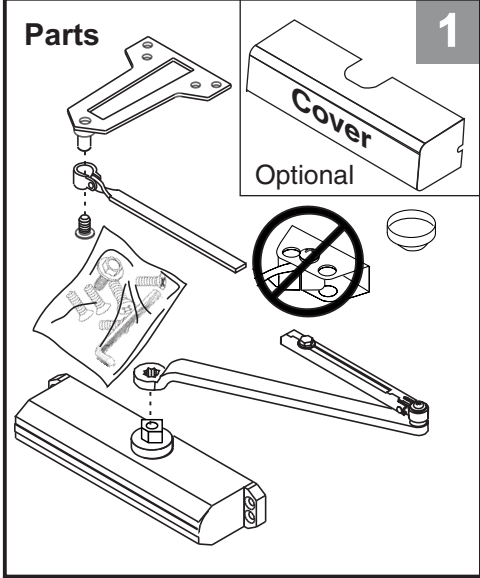

Door Opening	A	B
To 100°	9-1/4 (235)	7-5/8 (194)
101° to 130°	7-3/4 (197)	6-1/8 (156)
* 131° to 180°	5-3/4 (146)	4-1/8 (105)

\* Door/Wall/Hardware/Jamb conditions permitting

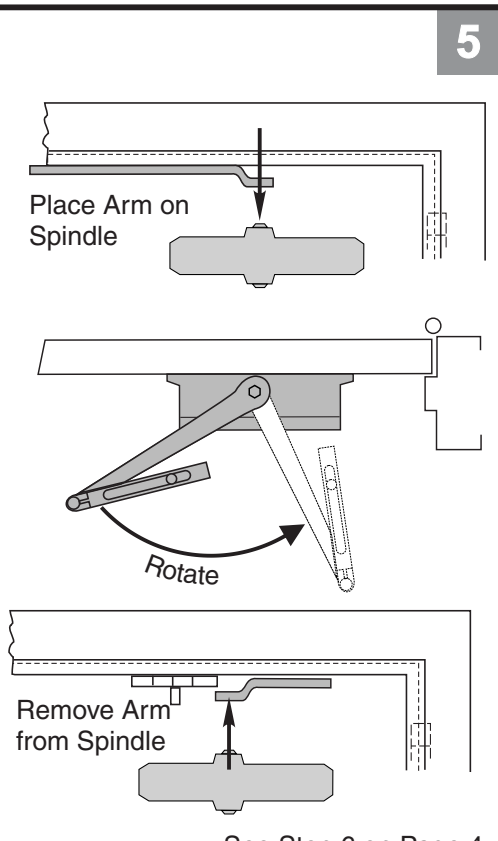
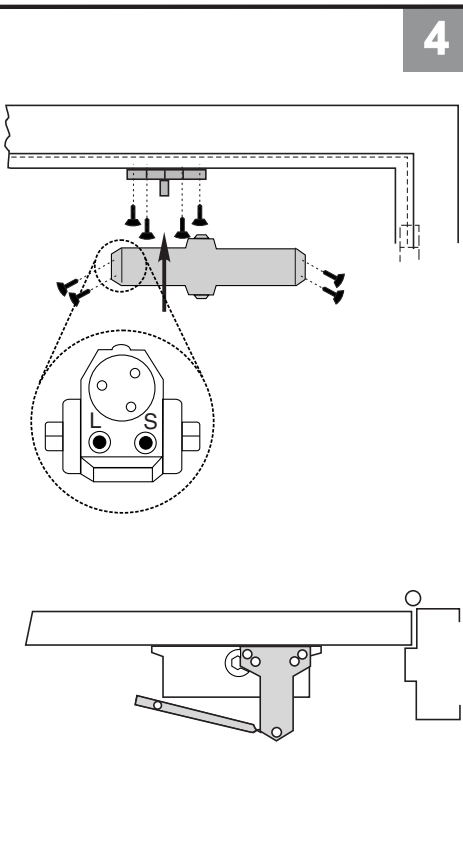
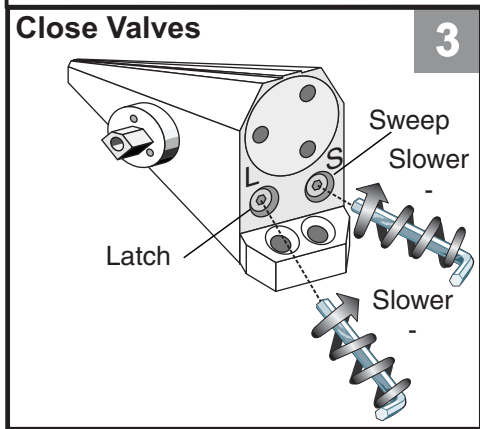
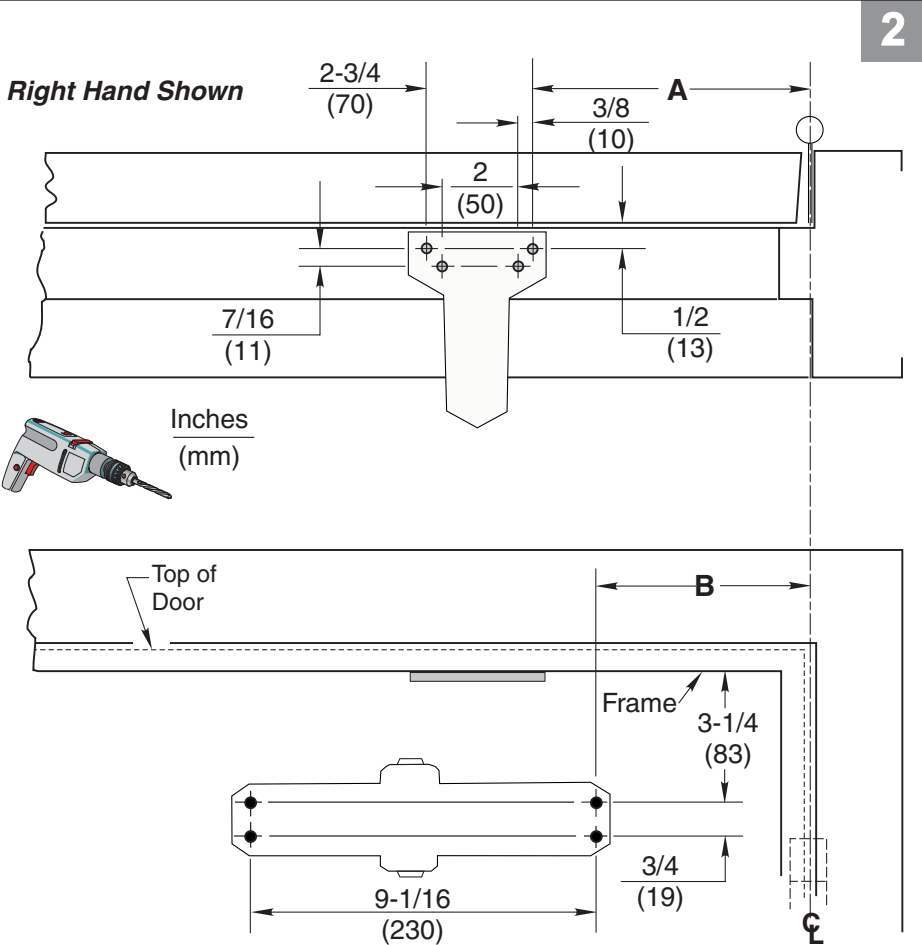

See Step 6 on Page 4

# 1130 Series

## Non Hold Open Door Closers — Parallel Arm

80-9311-0011-021 Rev 2

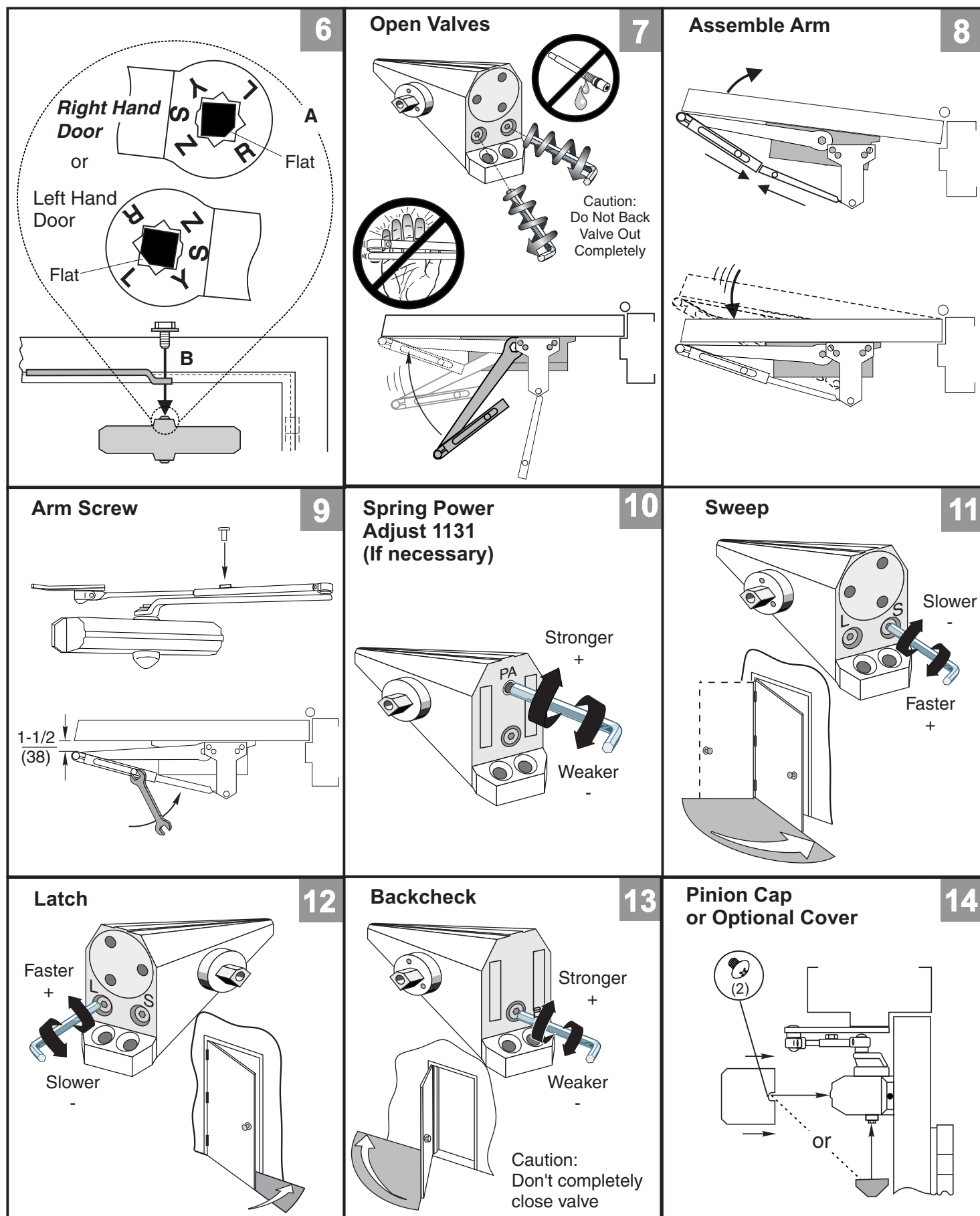

# 1130 Series

## Non Hold Open Door Closers — Top Jamb Arm

80-9311-0011-021 Rev 2

### Parts

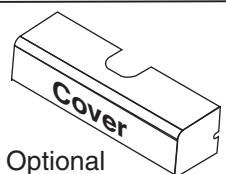
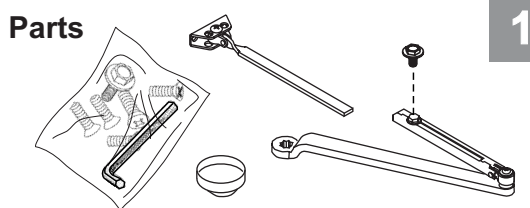

Optional

1

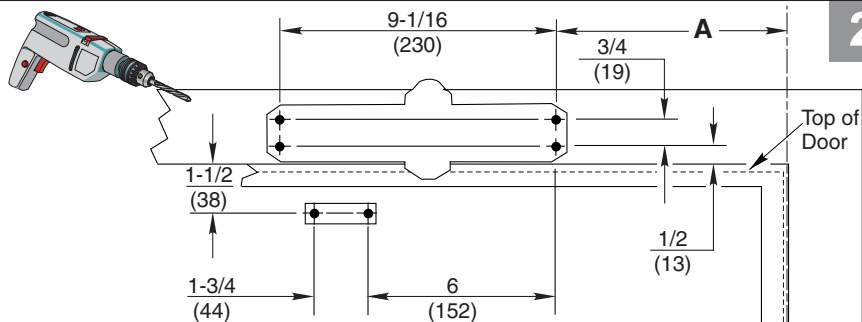

2

Right Hand Shown

Inches  
(mm)

\* Door/Wall/Hardware/Jamb  
conditions permitting

Opening	Dimension "A"
To 100°	7-1/2 (191)
101° to 120°	6 (152)
*121° to 180°	3-1/2 (89)

A longer connecting  
rod is required  
for reveals greater  
than 3" (76)

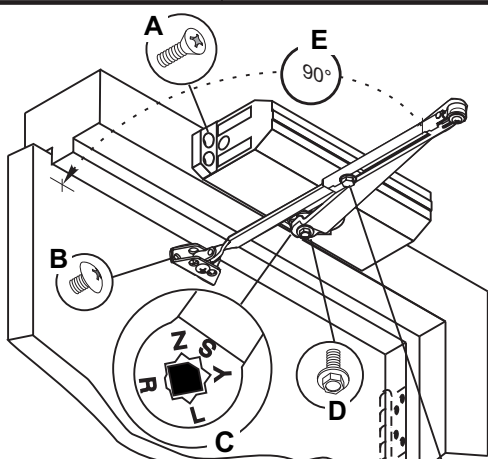
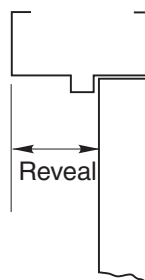

3

### Sweep

4

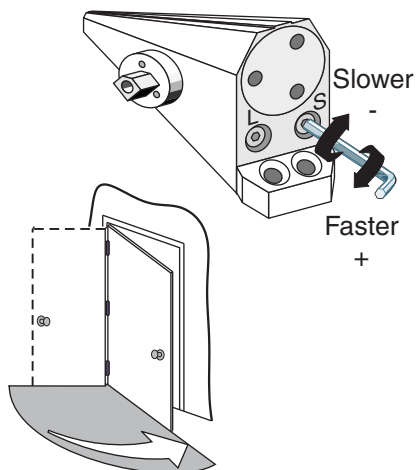

### Latch

5

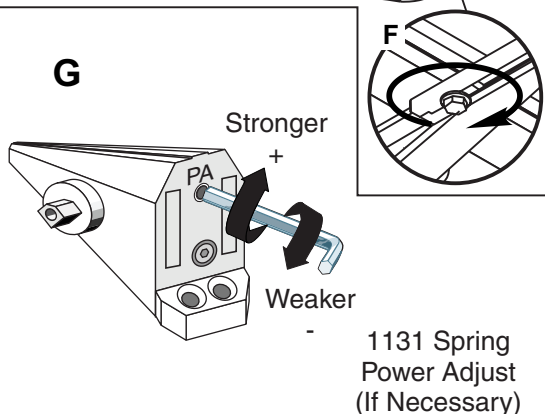
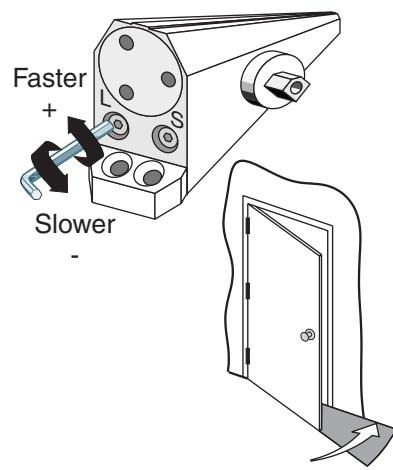

1131 Spring  
Power Adjust  
(If Necessary)

### Backcheck

6

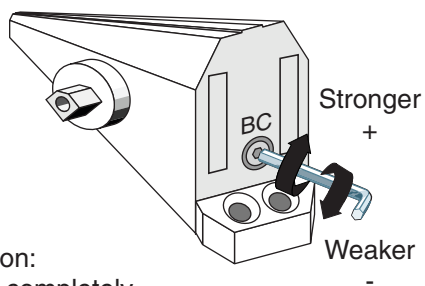

Caution:  
Don't completely  
close valve

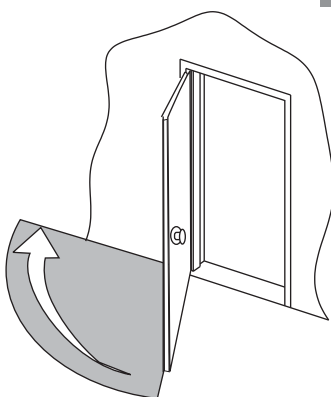

### Pinion Cap or Optional Cover

7

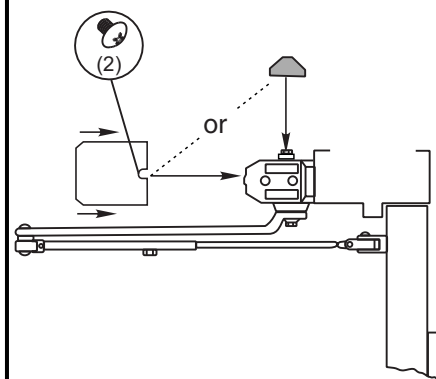

# 1130 Series Adjustments Page

ASSA ABLOY, the global leader in door opening solutions

For installation assistance, contact SARGENT at 800-810-WIRE (9473)

Copyright © 2016, Sargent Manufacturing Company, an ASSA ABLOY Group company. All rights reserved.

Reproduction in whole or in part without the express written permission of Sargent Manufacturing Company is prohibited.

**SARGENT®**

**ASSA ABLOY**

80-9311-0011-021 Rev 2

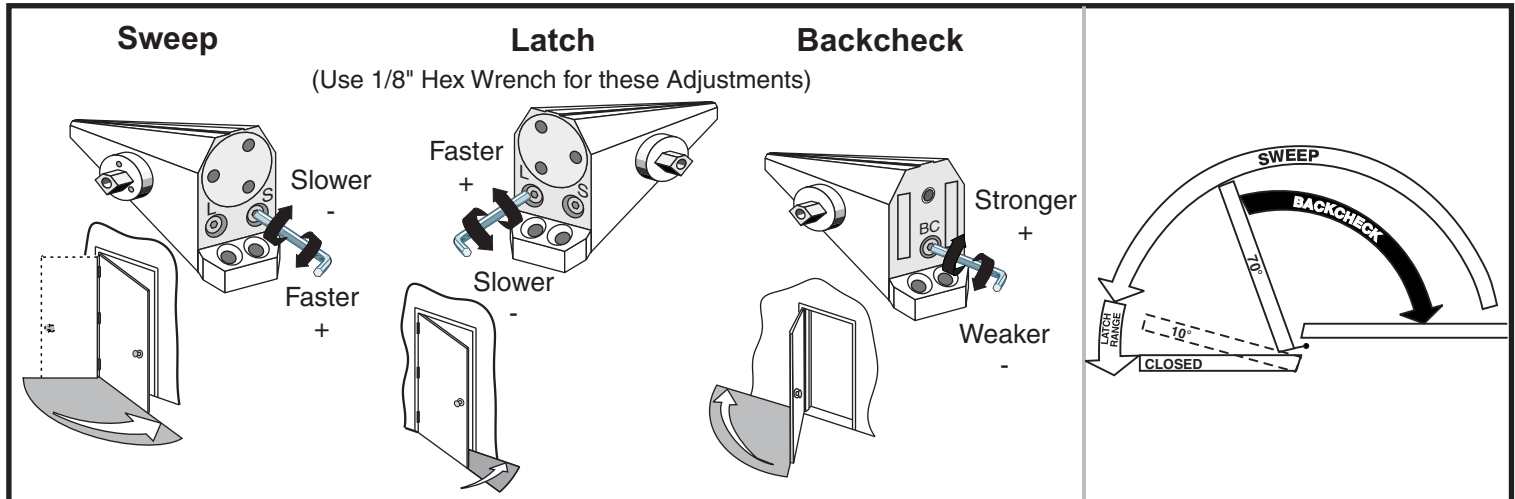

## Spring Power Adjust 1131

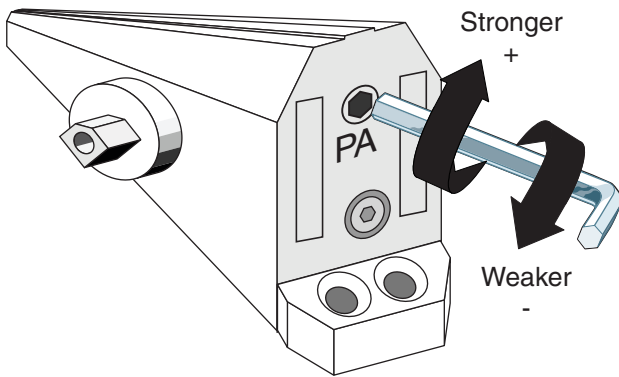

(Use 3/16" Hex Wrench for this Adjustment)

Adjustment Chart				Number of Turns Required				
	DOOR	TYPE OF INST.	*	MAXIMUM DOOR SIZE				
				34" (0.85M)	36" (0.90M)	40" (1.00M)	44" (1.10M)	48" (1.20M)
1131	INTERIOR	Regular Arm Top Jamb	FULL 360° TURNS OF 3/16 POWER ADJUSTMENT WRENCH	2	4	6	10	12
		Parallel Arm		3	5	8	11	14
	EXTERIOR	Regular Arm Top Jamb		3	5	8	11	14
		Parallel Arm		5	8	11	16	19

\*30 FULL (360°) TURNS MAXIMUM AVAILABLE  
 = 8 Turns As Shipped

### To identify your model:

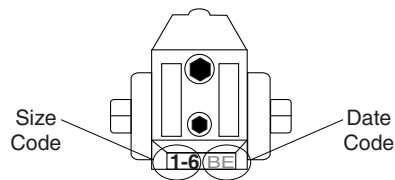

1-6=1131

### Arm Placement in Shoe

