

Mounting details

Hinge (Pull) Side
Mounting

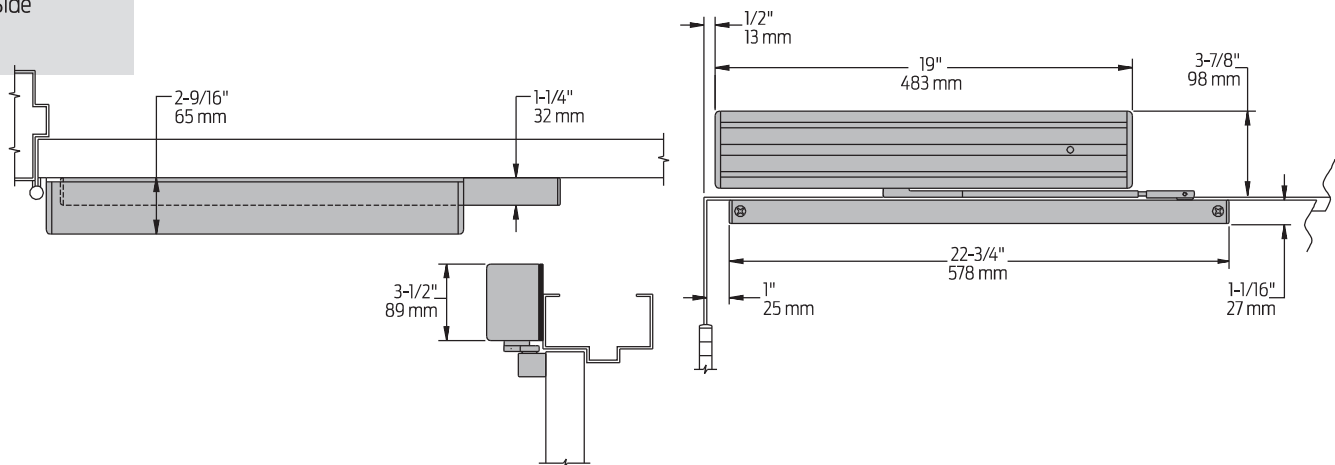

Butt Hinges	Should not exceed 4-1/2" (114 mm) in width
Top Rail	1-1/16" (27 mm) minimum
Reveal	<ul style="list-style-type: none">Should not exceed 1/8" (3 mm) for Swing-Free armShould not exceed 2-11/16" (68 mm) for double egress arm
Head Frame	Requires 2" (51 mm) minimum
Clearance	1-1/4" (32 mm) behind door required for installation
Bypass	<ul style="list-style-type: none">(suffix "B80 or B140") eliminates hold-open function up to a specified point of the doors swingB80 cylinder from 0° to 80°B140 cylinder from 0° to 140°
Maximum Opening	<ul style="list-style-type: none">Templating allows 180° with hold-open points up to 160°Optional double egress arm limited to 95°Please note that many track style door closers are capable of allowing 180° of door swing.Be aware that the majority of track style closers are at their weakest closing force in the 180° – 130° rangeConsult factory for applications where exterior or large/heavy door must swing 180°
ME Electrical Options	<ul style="list-style-type: none">These assemblies have a single electrical circuit with a choice of voltagesA separate TRANSFORMER, 4040SE-3210, can be used to reduce line voltage to 24V ACCircuitry accepts either AC or DC inputPlease specify 24V or 120V
Options	<ul style="list-style-type: none">Hold-open bypass24V or 120 volt input, please specify

ME (4310, 4410)
Wiring Diagram

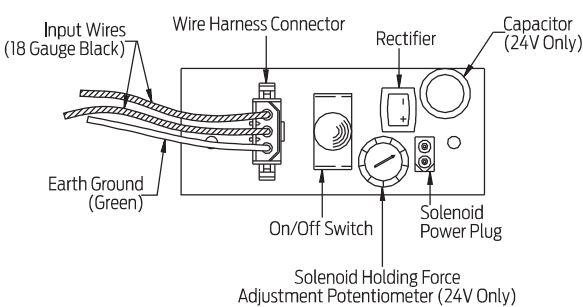

Notes:

- Information applies to ME closer
- Functions as full rack and pinion door closer when hold-open is not engaged or when current is interrupted with Swing-Free arm engaged
- Swing free arm allows door to be moved without door closer resistance