

MLRK1-MRK



INSERT INSTRUCTIONS

The Command Access MLRK1 is a field installable motorized latch-retraction kit for:

- MLRK1-MRK - Marks M9900 series devices
- MLRK1-DH - Design Hardware 1000 series device

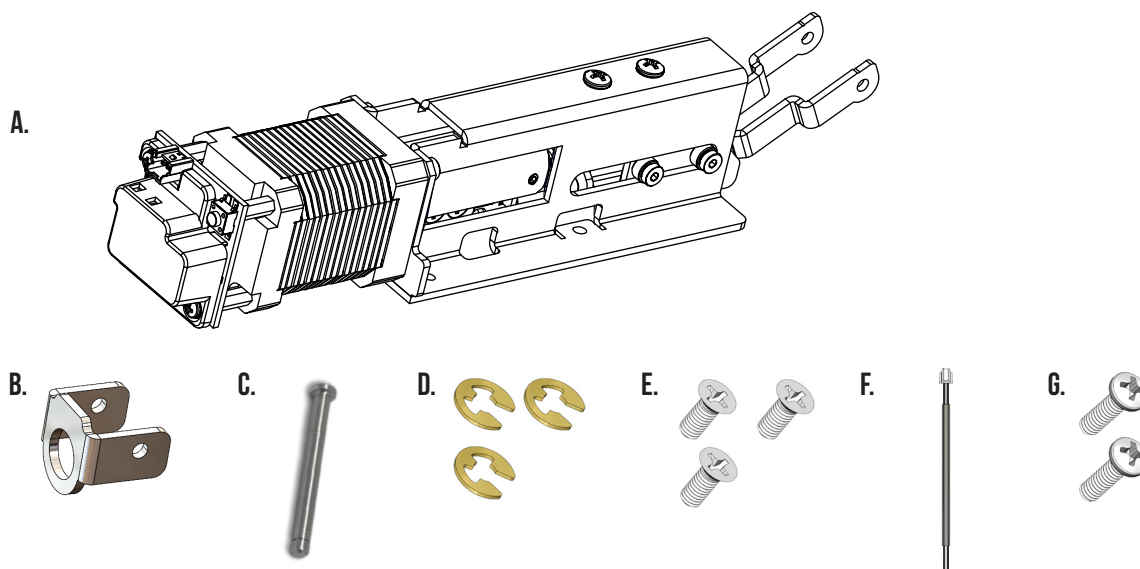

KIT INCLUDES

- | | |
|---|---------------------------------------|
| A. (1) 60412 - MLRK1-MRK | F. (1) 50944 - MOLEX PIGTAIL |
| B. (1) 51222 - CONNECTING BRACKET | G. (2) 40361 - M2 POSITION SET SCREWS |
| C. (1) 51048 - CONNECTING PIN | |
| D. (3) 40067 - E-CLIP (2 EXTRA) | |
| E. (3) 40064 - M4 FLAT HEAD SCREW (1 EXTRA) | |



INSTALLATION VIDEO

SPECIFICATIONS

- INPUT VOLTAGE: 24VDC +/- 10%
- AVERAGE LATCH RETRACTION CURRENT: 900 MA
- AVERAGE HOLDING CURRENT: 215 MA
- WIRE GAUGE: MINIMUM 18 GAUGE
- DIRECT WIRE RUN - NO RELAYS OR ACCESS CONTROL UNITS IN-BETWEEN POWER SUPPLY & MODULE

OPTIONAL BUILT-IN REX

- SPDT - RATED .5A @24V
- GREEN= COMMON (C)
- BLUE = NORMALLY OPEN (NO)
- GREY = NORMALLY CLOSED (NC)

RECOMMENDED POWER SUPPLIES: USE A POWER LIMITED CLASS 2 POWER SUPPLY

ALL COMMAND ACCESS EXIT DEVICES & FIELD INSTALLABLE KITS HAVE BEEN THOROUGHLY CYCLE TESTED WITH COMMAND ACCESS POWER SUPPLIES AT OUR FACTORY. IF YOU PLAN ON USING A NON-COMMAND POWER SUPPLY IT MUST BE A FILTERED & REGULATED LINEAR POWER SUPPLY.

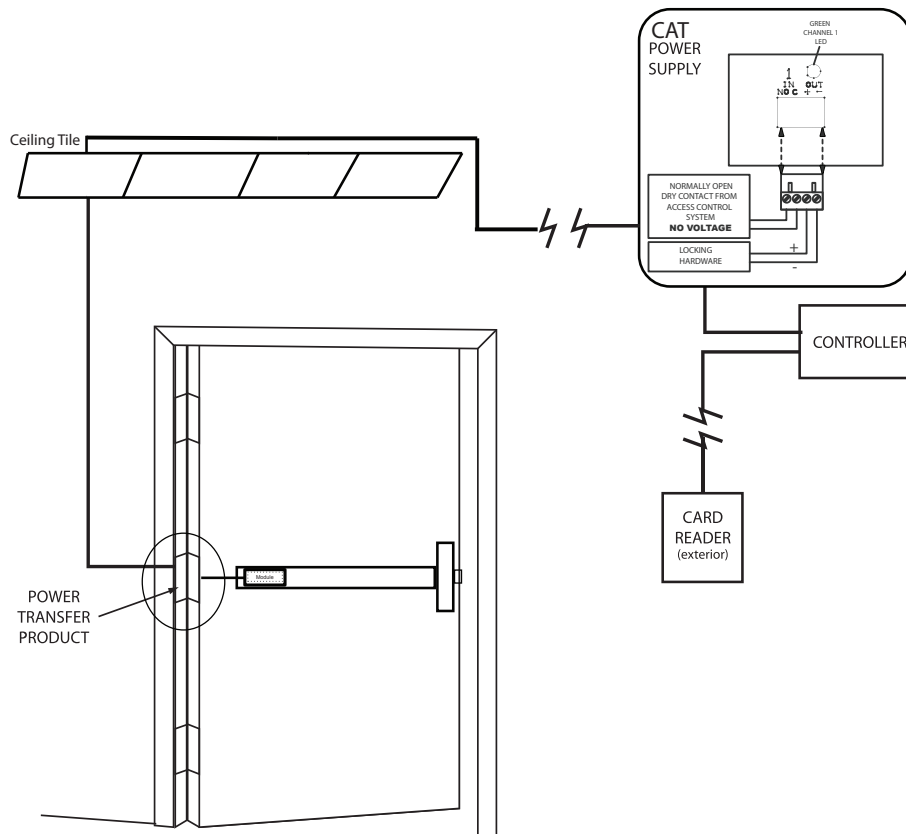

SETTING PUSH TO SET (PTS)

TO PUT THE DEVICE IN PTS MODE, FOLLOW THESE STEPS:

- Depress the MM5 button.
- Apply power and listen for short beep, which indicates that the device is now in PTS mode.
- Remove power.
- Release the button, but make sure you don't release it until the power is no longer going to the motor.

SET ADJUSTMENT:

- Depress the pushpad fully then release it 1/32", & hold.
- Apply power.
- Continue to hold the pushpad until the device gives you long beep.
- Remove power.

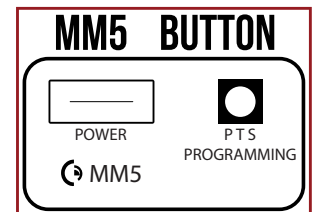

Note: Test the new location multiple times; if not to your liking, repeat the steps.

TROUBLESHOOTING & DIAGNOSTICS

BEEPS	EXPLANATION	SOLUTION
2 Beeps	Over Voltage	> 30V unit will shut down. Check voltage & adjust to 24 V.
3 Beeps	Under Voltage	< 20V unit will shut down. Check voltage & adjust to 24 V.
4 Beeps	Failed Sensor	Verify all 3 sensor wires are installed correctly. Replace sensor if problem persists by contacting office.
5 Beeps	Retraction or dogging failure	After 1st fail: 5 beeps then immediately attempts to retract again. After 2nd fail: 5 beeps with pause in-between for 30 seconds then device attempts to retract again. After 3rd fail: 5 beeps every 7 minutes, device will not attempt to retract. To Reset: Depress bar for 5 seconds at any time.

1. Slide off **push pad assembly** from exit device.

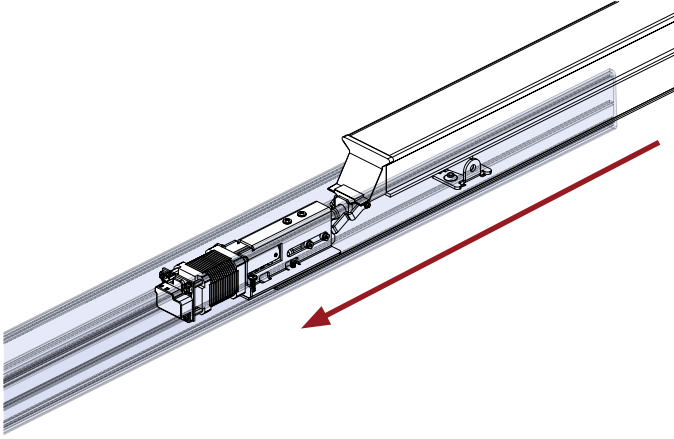

2. Remove existing dogging assembly (if equipped)

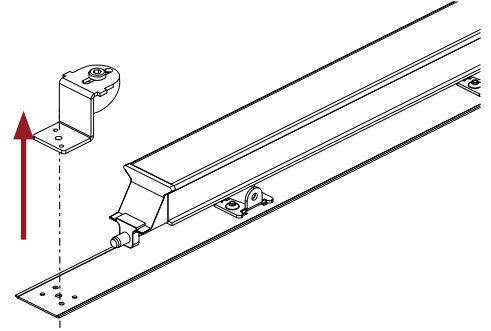

3. Install two (E) screws from underneath the baserail and into the Motor Bracket.

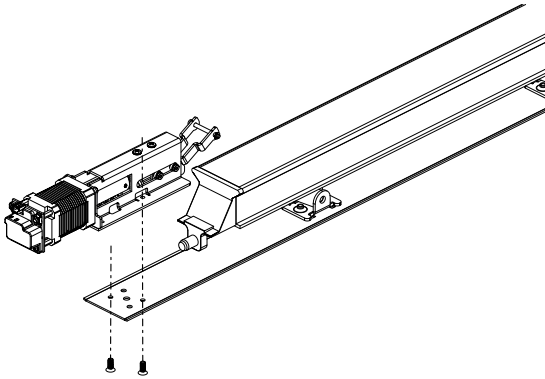

4. Slide the (B) **Connecting Bracket** over the Dogging post at the end of the push pad. Insert (C) **Connecting Pin** through connecting bracket and snap on (D) **E-Clip**.

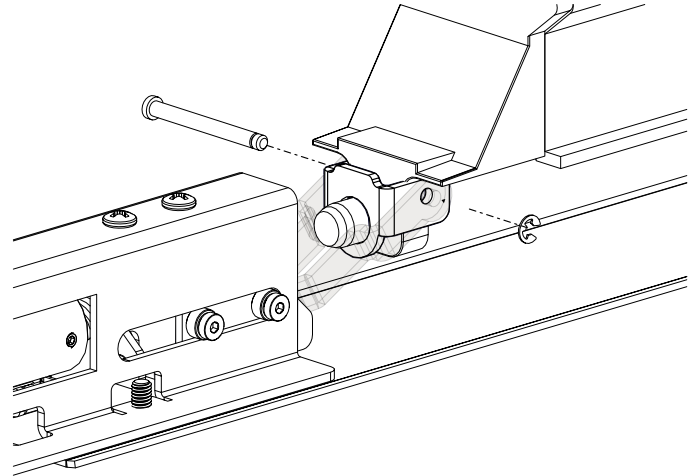

5. Screw in (G) **Position Set Screws (2)** a few threads until flush with the bottom of the motor bracket.

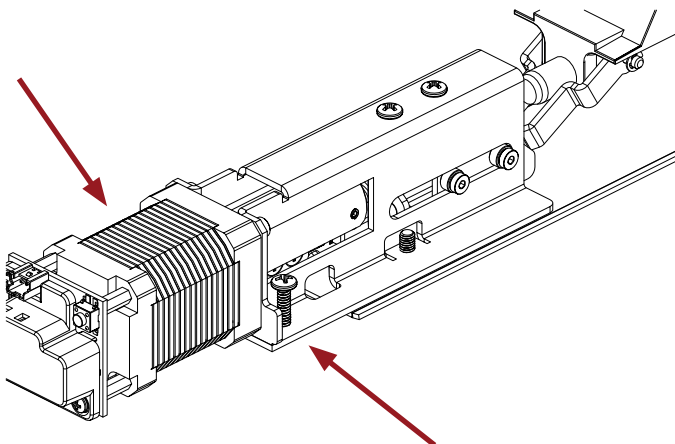

6. Re-install **Base Rail** into **Housing**.

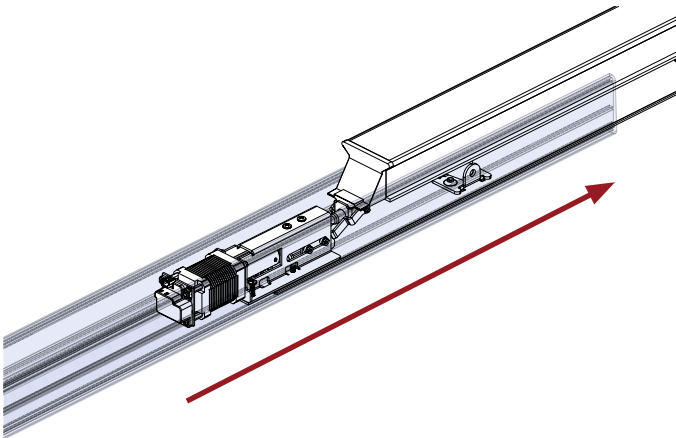

7. Once in position, securely tighten the two **Position Set Screws**.

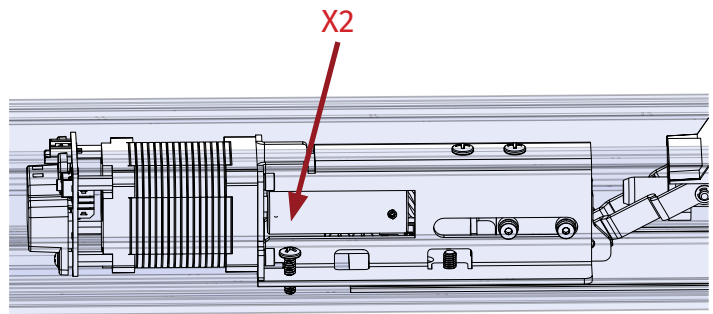

8. Set the "**Push to Set Adjustment**" following the steps on page 2.



SETTING PUSH TO SET (PTS)

TO PUT THE DEVICE IN PTS MODE, FOLLOW THESE STEPS:

- Depress the MM5 button.
- Apply power and listen for short beep, which indicates that the device is now in PTS mode.
- Remove power.
- Release the button, but make sure you don't release it until the power is no longer going to the motor.

SET ADJUSTMENT:

- Depress the pushpad fully then release it 1/32", & hold.
- Apply power.
- Continue to hold the pushpad until the device gives you long beep.
- Remove power.

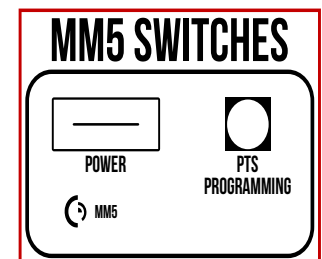

Note: Test the new location multiple times; if not to your liking, repeat the steps.