

ASSA ABLOY

1130-HU Series

Non Handed Door Closer

Non Handed Door Closer

1131-HU



Regular Arm Installation See Page 2

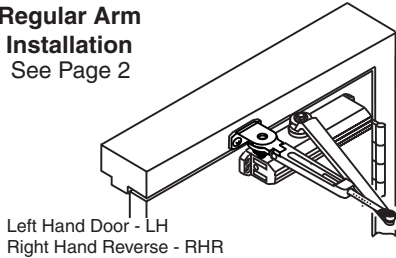

CAUTION

An Incorrectly installed or improperly adjusted door closer can cause property damage or personal injury. These installation instructions should be followed to avoid the possibility of misapplication or misadjustment.

CAUTION

Regular Arm Installation See Page 2

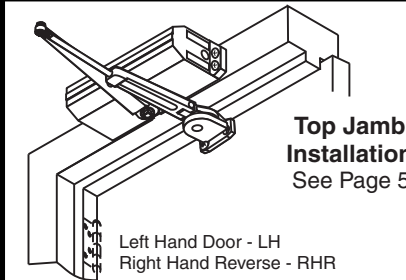
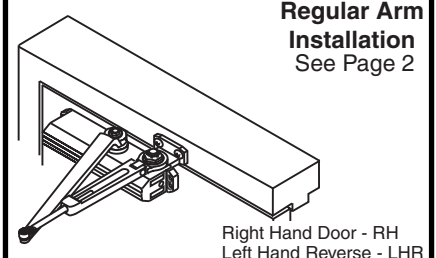

NOTE: For special applications a separate door and frame preparation template is packed with these instructions. Use this instruction sheet for installation sequence and closer adjustments only.

- Doors should be hung on ball bearing or anti-friction hinges.
- A separate door stop is recommended.
- Door and frame must be properly reinforced.
- Adjust closing time speed between 3 and 7 seconds from 90° to 0°.
- These door closers should NOT be installed on the exposed side (weather side) of exterior doors.

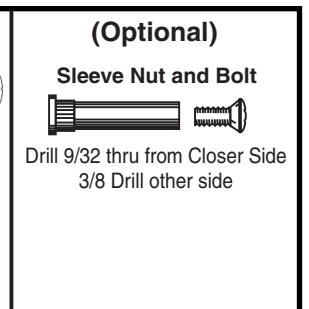
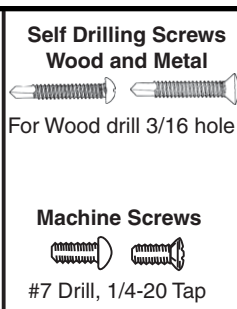
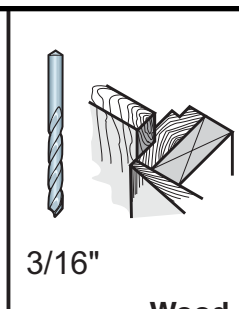
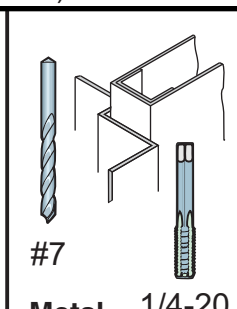
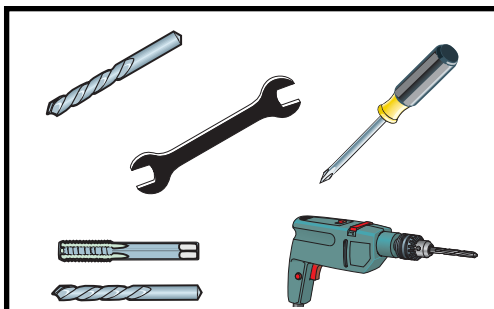
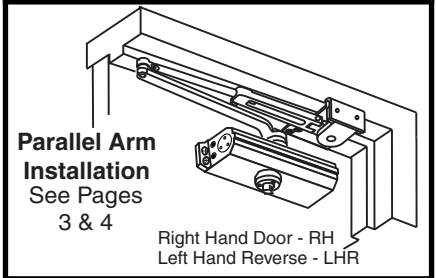
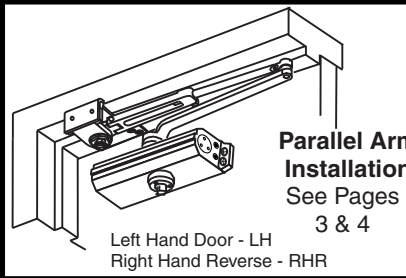
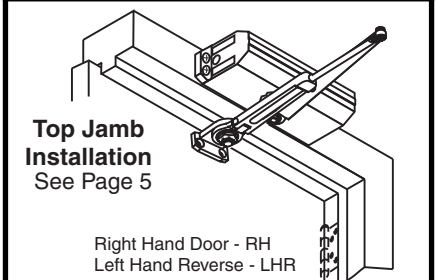

Standard Components

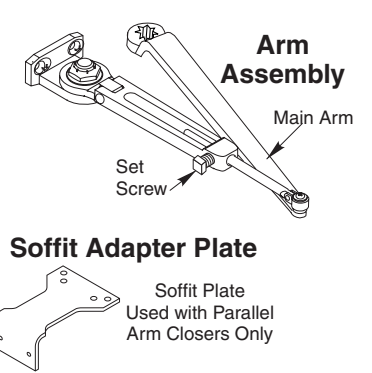
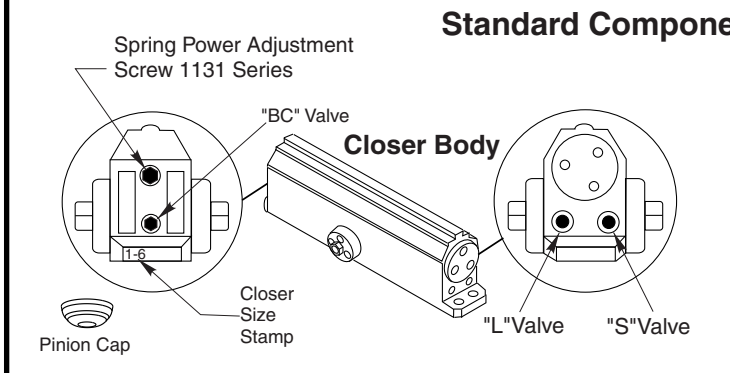

Optional Components

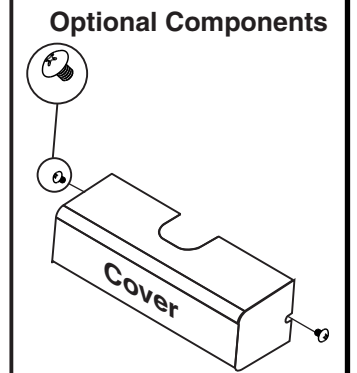

1130-HU Series

Hold Open Arm Door Closers — Regular Arm

80-9311-0012-021 Rev 2

SARGENT®

ASSA ABLOY

Parts

1

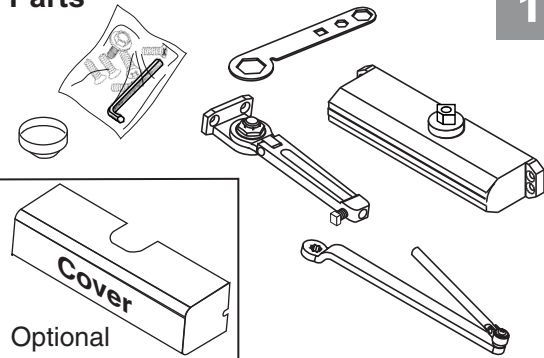

3

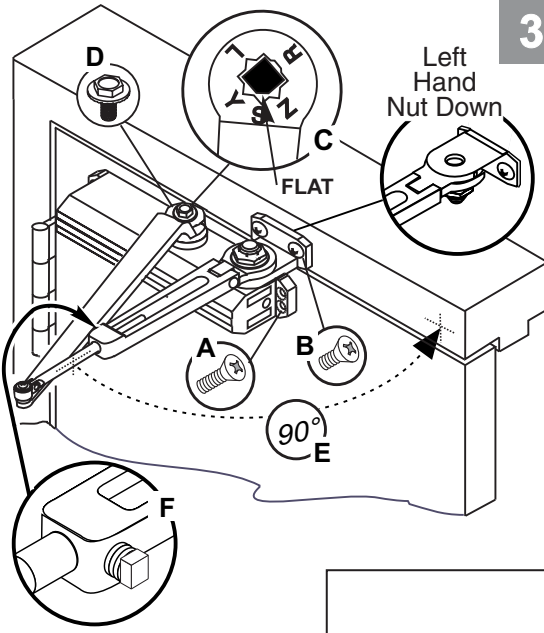

G

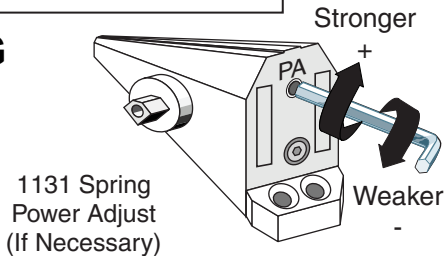

Backcheck

6

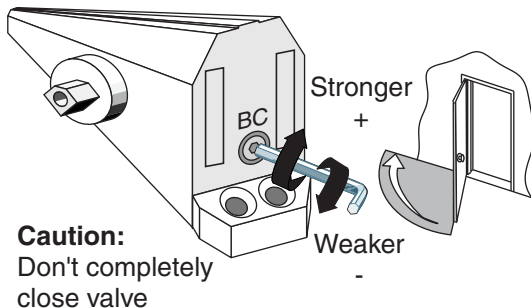

Set Hold Open

7

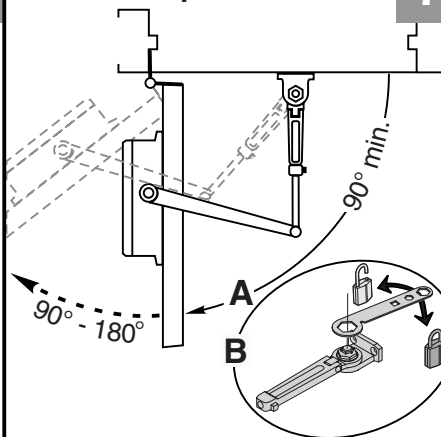

Pinion Cap or Optional Cover

8

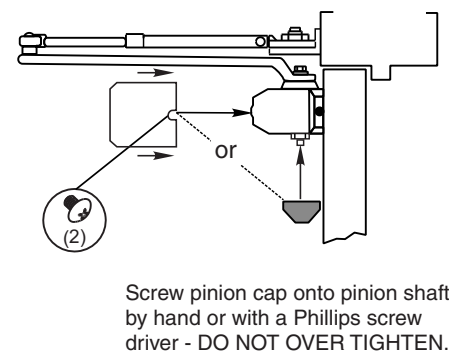

2

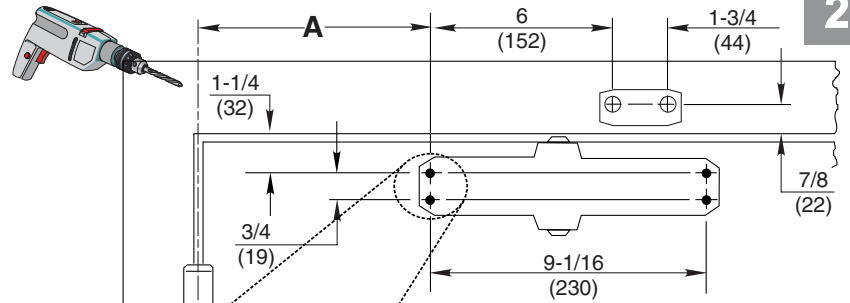

Right Hand Shown

| Opening | Dimension "A" |
|----------------|----------------------|
| To 100° | $\frac{7}{(178)}$ |
| 101° to 120° | $\frac{6}{(152)}$ |
| * 121° to 180° | $\frac{3-1/2}{(89)}$ |

Inches
(mm)

"L" and "S" valves
toward hinge

* Door/Wall/Hardware/Jamb
conditions permitting

Sweep

4

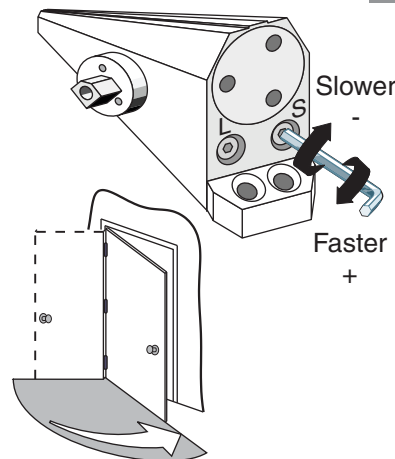

Latch

5

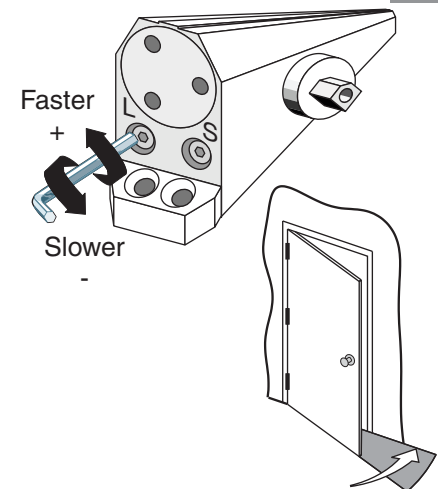

80-9311-0012-021 Rev 2

ASSA ABLOY

1

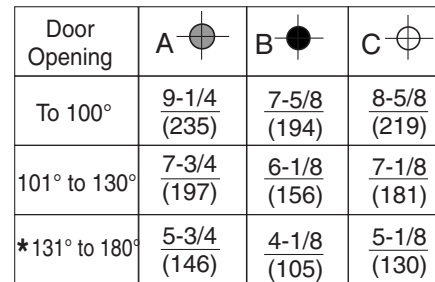

2

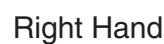

1130-HU Series

Hold Open Arm Door Closers — Parallel Arm

80-9311-0012-021 Rev 2

SARGENT®

ASSA ABLOY

| | | | |
|--|---|---|---|
| <p>6</p> <p>Right Hand Door or Left Hand Door</p> <p>Flat</p> <p>Flat</p> <p>A</p> <p>B</p> | <p>7</p> <p>Open Valves</p> <p>Caution: Do Not Back Valves out Completely</p> | <p>8</p> <p>Assemble Arm</p> | |
| <p>9</p> <p>Arm Screw</p> <p>1-1/2 (38)</p> | <p>10</p> <p>Spring Power Adjust 1131 (If necessary)</p> <p>Stronger + Weaker -</p> | <p>11</p> <p>Sweep</p> <p>Slower - Faster +</p> | <p>12</p> <p>Latch</p> <p>Faster + Slower -</p> |
| <p>13</p> <p>Backcheck</p> <p>Stronger + Weaker -</p> <p>Caution: Don't completely close valve</p> | <p>14</p> <p>Set Hold Open</p> <p>70° to 180°</p> | <p>15</p> <p>Pinion Cap or Optional Cover</p> <p>(2)</p> <p>or</p> <p>Screw pinion cap onto pinion shaft by hand or with a Phillips screw driver - DO NOT OVER TIGHTEN.</p> | |

1130-HU Series

Hold Open Arm Door Closers — Top Jamb Arm

80-9311-0012-021 Rev 2

SARGENT®

ASSA ABLOY

Parts

1

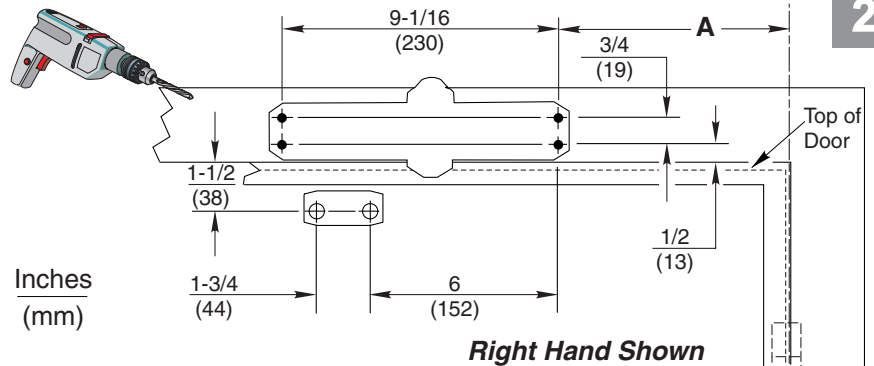
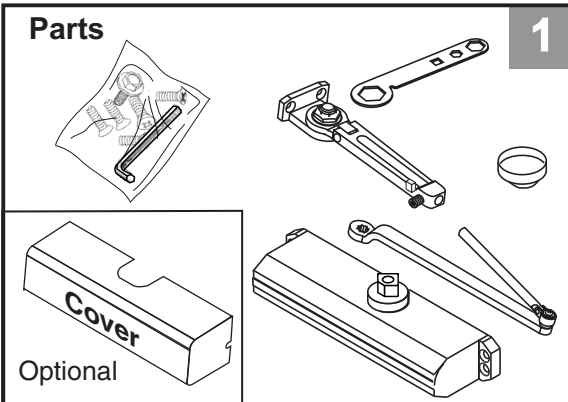

2

* Door/Wall/Hardware/Jamb conditions permitting

| Opening | Dimension "A" |
|---------------|---------------|
| To 100° | 7-1/2 (191) |
| 101° to 120° | 6 (152) |
| *121° to 180° | 3-1/2 (89) |

Longer connecting rod is required for reveals greater than 3" (76)

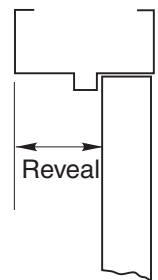

3

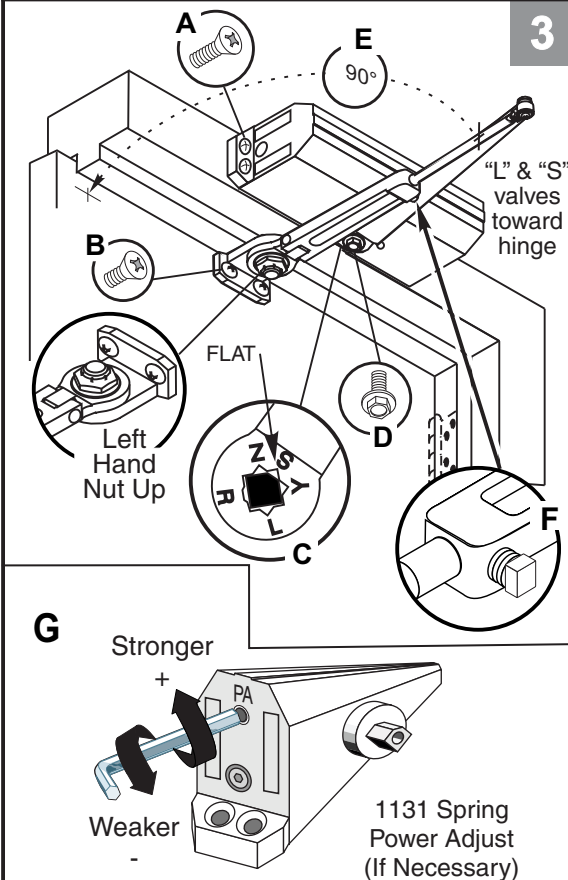

Sweep

4

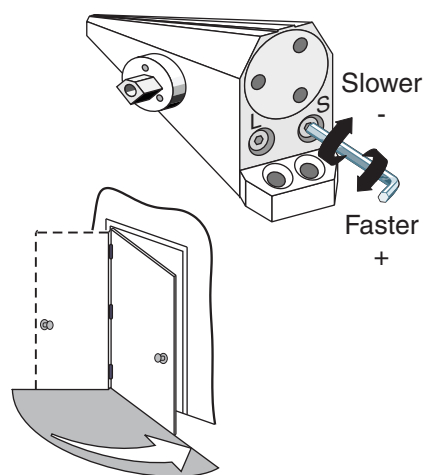

Latch

5

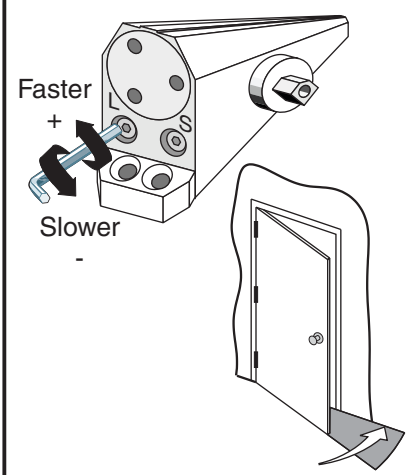

6

Backcheck

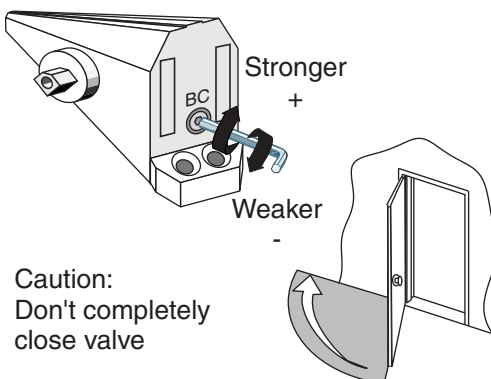

Set Hold Open

7

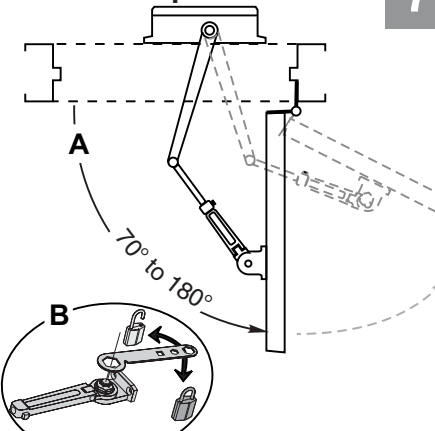

Pinion Cap or Optional Cover

8

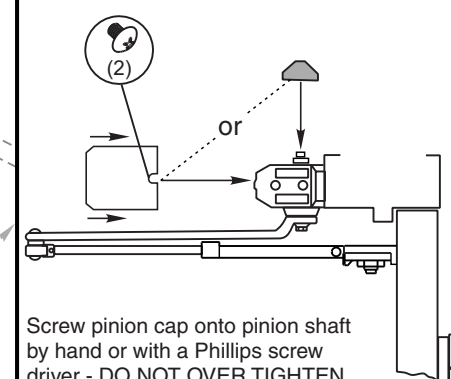

1130-HU Series Adjustments Page

80-9311-0012-021 Rev 2

Sweep

Slower -
Faster +

Latch

(Use 1/8" Hex Wrench for these Adjustments)

Faster +
Slower -

Backcheck

Stronger +
Weaker -

SWEEP
BACKCHECK
CLOSED
LATCH RANGE

Spring Power Adjust 1131

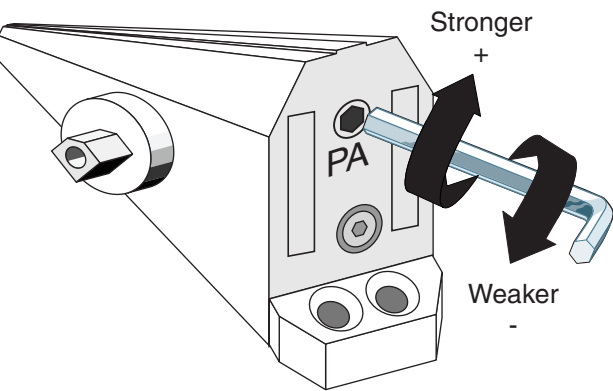

(Use 1/8" Hex Wrench for this Adjustment)

| Adjustment Chart | | | | Number of Turns Required | | | | |
|---|----------|-------------------------|---|--------------------------|----------------|----------------|----------------|----------------|
| | DOOR | TYPE OF INST. | * | MAXIMUM DOOR SIZE | | | | |
| | | | | 34" (0.85M) | 36" (0.90M) | 40" (1.00M) | 44" (1.10M) | 48" (1.20M) |
| 1131 | INTERIOR | Regular Arm Top Jamb | FULL 360° TURNS OF 3/16 POWER ADJUSTMENT WRENCH | 2 | 4 | 6 | 10 | 12 |
| | | Parallel Arm | | 3 | 5 | 8 | 11 | 14 |
| | EXTERIOR | Regular Arm Top Jamb | | 3 | 5 | 8 | 11 | 14 |
| | | Parallel Arm | | 5 | 8 | 11 | 16 | 19 |
| *30 FULL (360°) TURNS MAXIMUM AVAILABLE | | | | | | | | |
|  | | | | = 8 Turns As Shipped | | | | |

To identify your model:

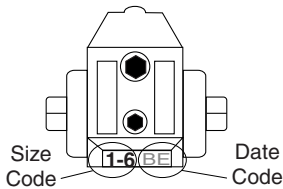

1-6=1131

To Set Hold Open

Open Door to Desired Angle

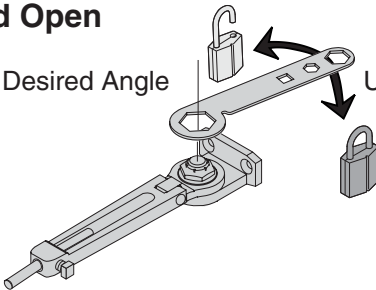

SARGENT
ASSA ABLOY

For installation assistance, contact SARGENT at 800-810-WIRE (9473)