

Installation Instructions

DL4000 Series Mortise Deadlock

If Thumbturn is not used, disregard those steps pertaining to its application.

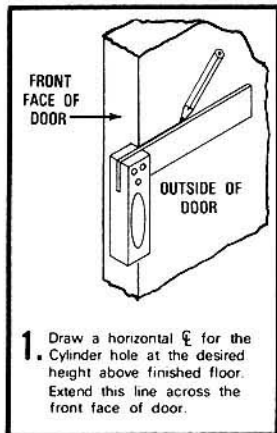
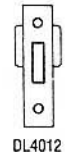
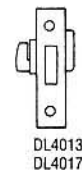

1. Draw a horizontal center line for the cylinder hole at the desired height above finished floor. Extend this line across the front face of door.

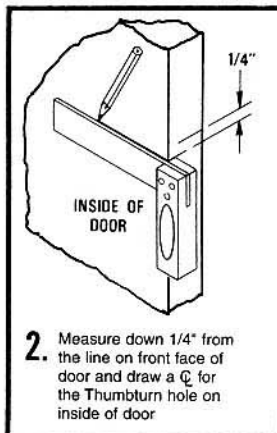

2. Measure down 1/4" from the line on front face of door and draw a center line for the Thumbturn hole on inside of door.

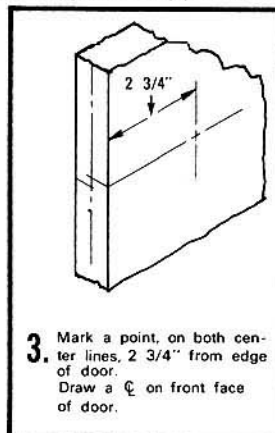

3. Mark a point, on both center lines, 2 3/4" from edge of door. Draw a center line on front face of door.

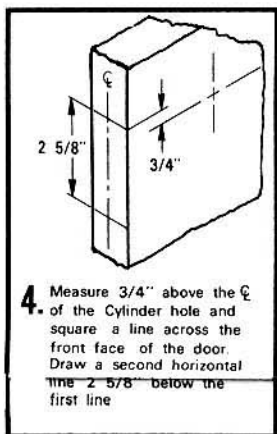

4. Measure 3/4" above the center line of the Cylinder hole and square a line across the front face of the door. Draw a second horizontal line 2 5/8" below the first line.

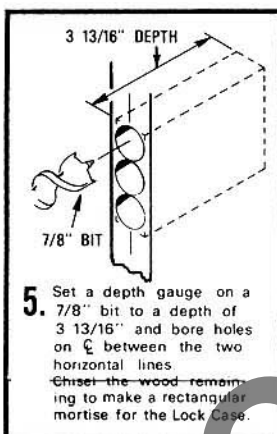

5. Set a depth gauge on a 7/8" bit to a depth of 3 13/16" and bore holes on center line between the two horizontal lines. Chisel the wood remaining to make a rectangular mortise for the Lock Case.

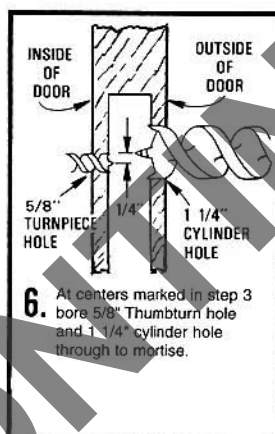

6. At centers marked in step 3 bore 5/8" Thumbturn hole and 1 1/4" cylinder hole through to mortise.

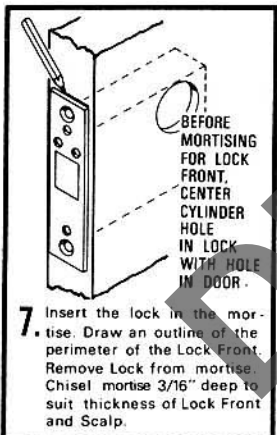
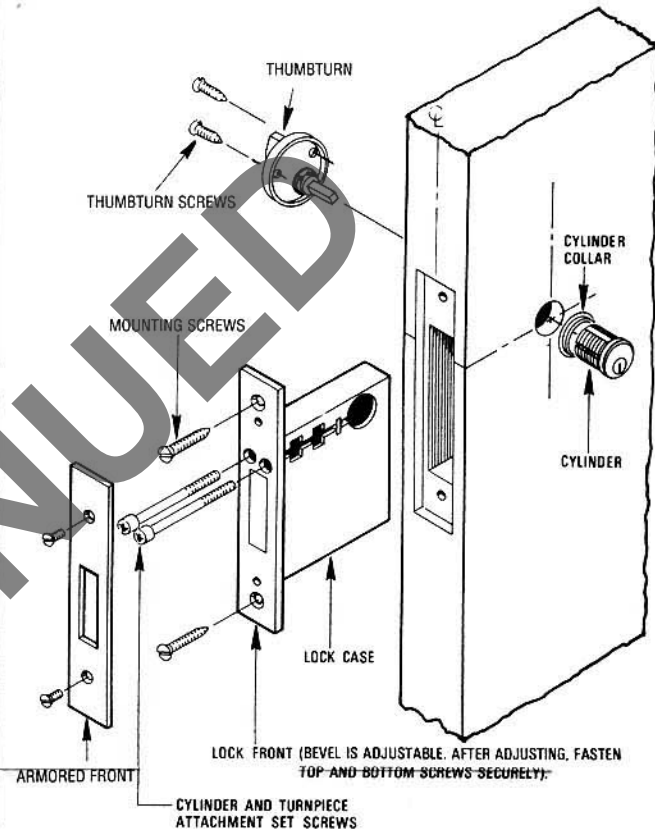

7. Insert the lock in the mortise. Draw an outline of the perimeter of the Lock Front. Remove Lock from mortise. Chisel mortise 3/16" deep to suit thickness of Lock Front and Scalp.

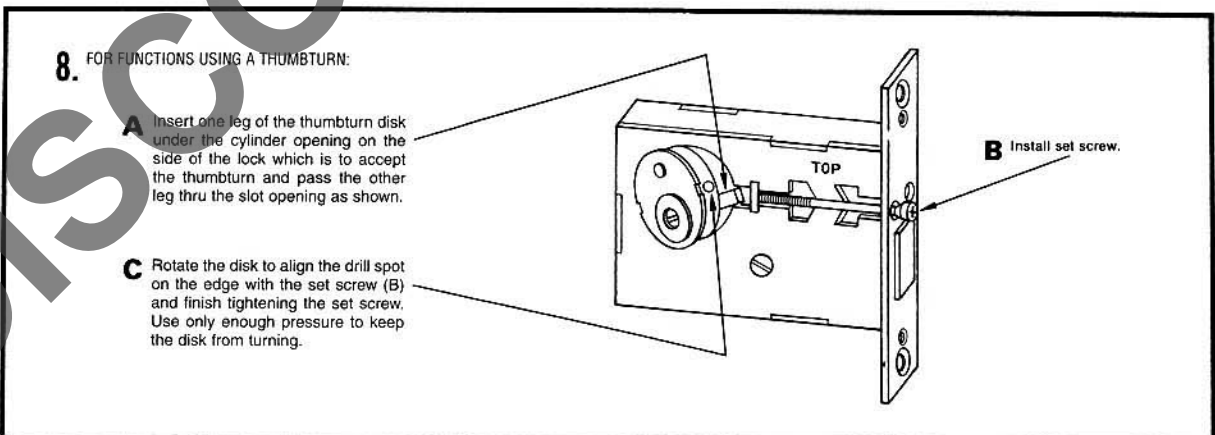

8. FOR FUNCTIONS USING A THUMBTURN:

A Insert one leg of the thumbturn disk under the cylinder opening on the side of the lock which is to accept the thumbturn and pass the other leg thru the slot opening as shown.

C Rotate the disk to align the drill spot on the edge with the set screw (B) and finish tightening the set screw. Use only enough pressure to keep the disk from turning.

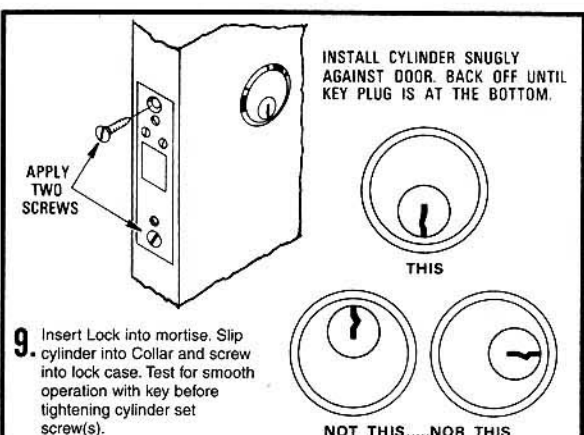

9. Insert Lock into mortise. Slip cylinder into Collar and screw into lock case. Test for smooth operation with key before tightening cylinder set screw(s).

INSTALL CYLINDER SNUGLY AGAINST DOOR. BACK OFF UNTIL KEY PLUG IS AT THE BOTTOM.

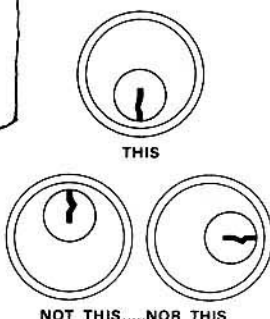

THIS
NOT THIS.....NOR THIS

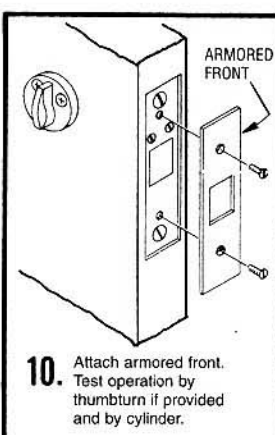

10. Attach armored front. Test operation by thumbturn if provided and by cylinder.

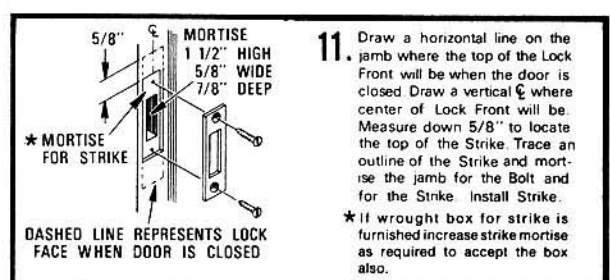

11. Draw a horizontal line on the jamb where the top of the Lock Front will be when the door is closed. Draw a vertical center line where center of Lock Front will be. Measure down 5/8" to locate the top of the Strike. Trace an outline of the Strike and mortise the jamb for the Bolt and for the Strike. Install Strike.

* If wrought box for strike is furnished increase strike mortise as required to accept the box also.

Corbin Russwin

Corbin Russwin Architectural Hardware
225 Episcopal Road Berlin, CT 06037 USA

FM-8C (617332000) Rev 12/00