

MLRK1-JAC12



BHMA
CERTIFIED

**NO HASSLE
WARRANTY**



INSERT INSTRUCTIONS

The Command Access MLRK1-JAC12 is a field installable motorized latch-retraction kit for:

- Jackson 1285, 1286 and 1295 series devices
- Kawneer 1686 and 1786 series devices
- AHT 8 and 9 series devices

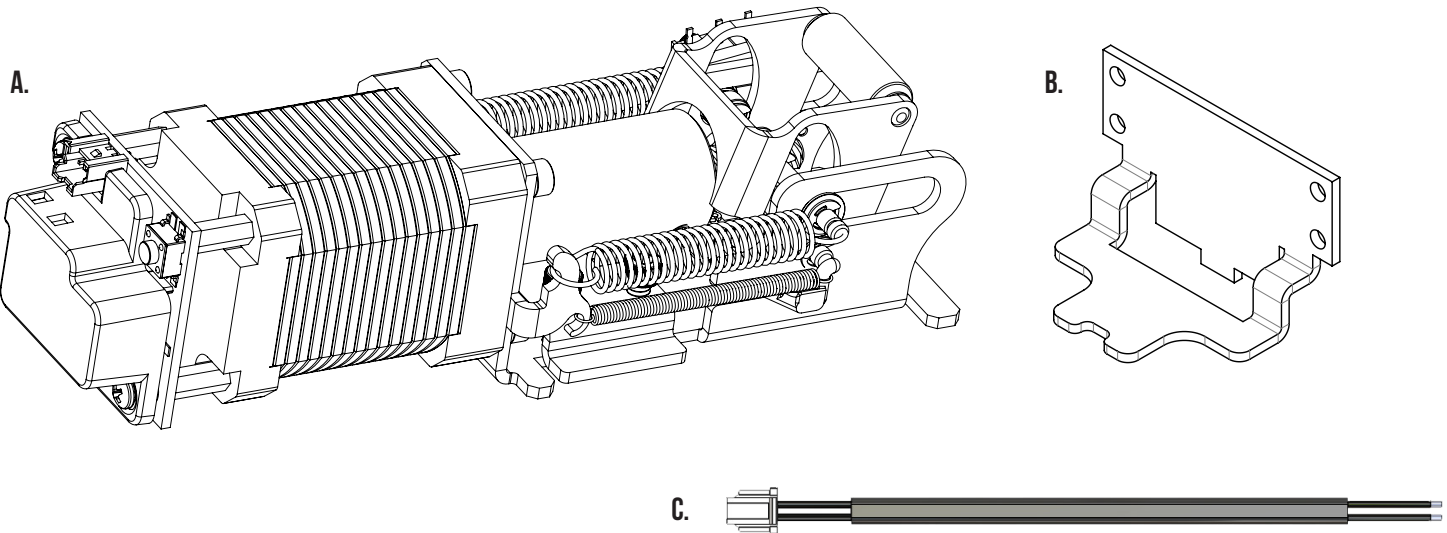

KIT INCLUDES

- A. (1) 60140 MOTOR KIT ASSEMBLY
- B. (1) 50516 END CAP LINK
- C. (1) 50944 POWER HARNESS



INSTALLATION VIDEO

SPECIFICATIONS

- INPUT VOLTAGE: 24VDC +/- 10%
- AVERAGE LATCH RETRACTION CURRENT: 900 MA
- AVERAGE HOLDING CURRENT: 215 MA
- WIRE GAUGE: MINIMUM 18 GAUGE
- DIRECT WIRE RUN - NO RELAYS OR ACCESS CONTROL UNITS IN-BETWEEN POWER SUPPLY & MODULE

OPTIONAL BUILT-IN REX

SPDT - RATED .5A @ 24VDC

- GREEN= COMMON (C)
- BLUE = NORMALLY OPEN (NO)
- GREY = NORMALLY CLOSED (NC)

RECOMMENDED POWER SUPPLIES: USE A POWER LIMITED CLASS 2 POWER SUPPLY

ALL COMMAND ACCESS EXIT DEVICES & FIELD INSTALLABLE KITS HAVE BEEN THOROUGHLY CYCLE TESTED WITH COMMAND ACCESS POWER SUPPLIES AT OUR FACTORY. IF YOU PLAN ON USING A NON-COMMAND POWER SUPPLY IT MUST BE A FILTERED & REGULATED LINEAR POWER SUPPLY.

- 1.** Remove device end cap, filler plate, mount bracket, and push pad end cap.

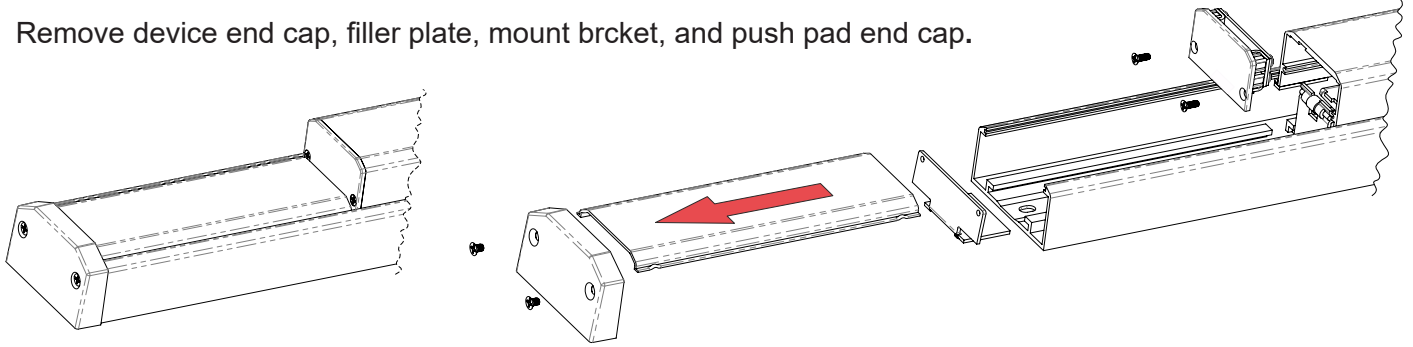

2a. Type 1 (Jackson Type)

Separate

Re-Assemble

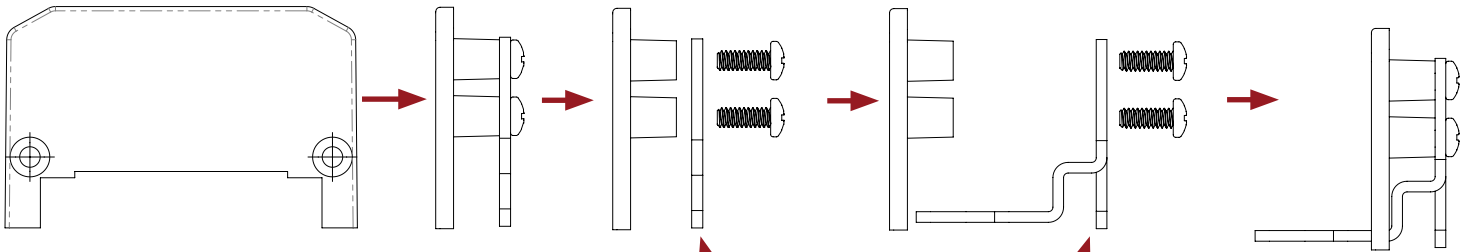

Replace guide plate with provided End Cap Link P# 50516

2b. Type 2 (AHT / Kawneer Type)

Separate

Discard Original Guide Plate

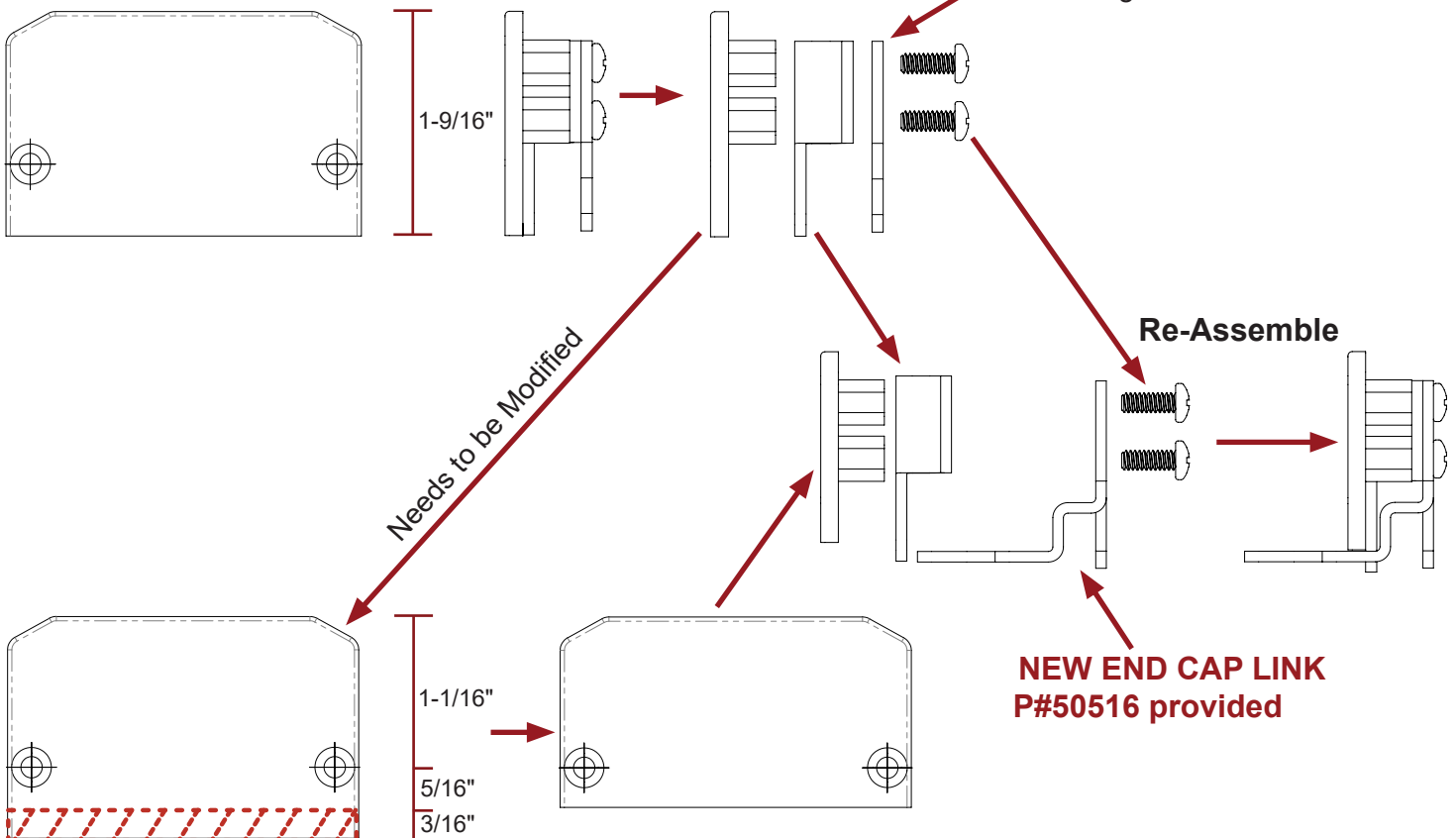

CUT 3/16" off the bottom

- 3.** Re-install End Cap with New End Cap Link into the push pad housing.

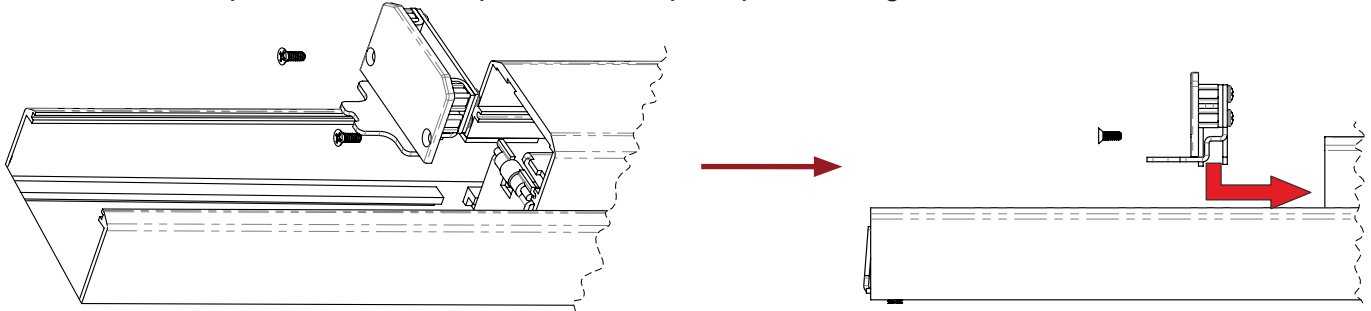

- 4.** Remove the protection cap and discard, then slide motor assembly into the base rail channel

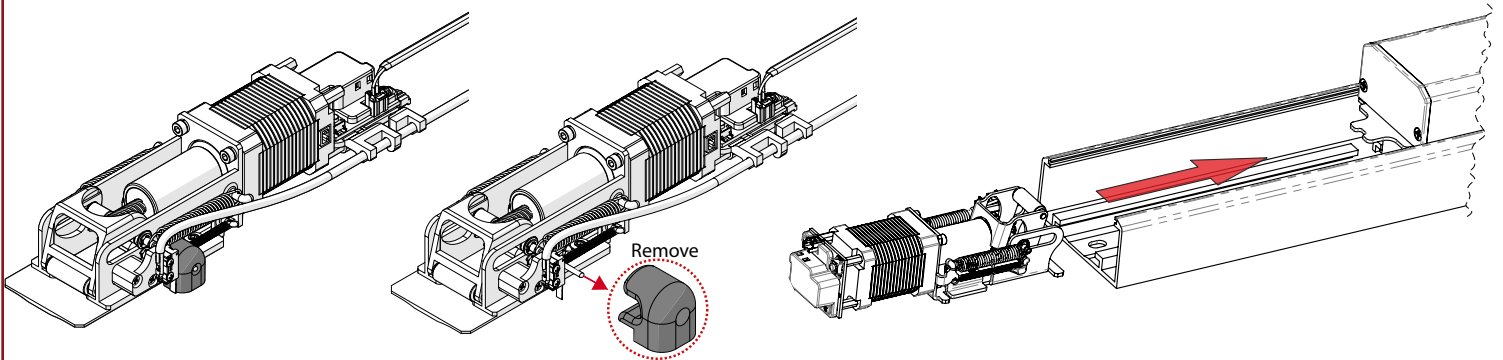

- 5.** Tighten screws (4) securely, then test functions and adjust PTS location (see page 4). Once complete, install rear bracket, filler plate, and device end cap to finish the installation.

End Cap Link goes **UNDERNEATH** the **ROLLER** on the front of the motor.

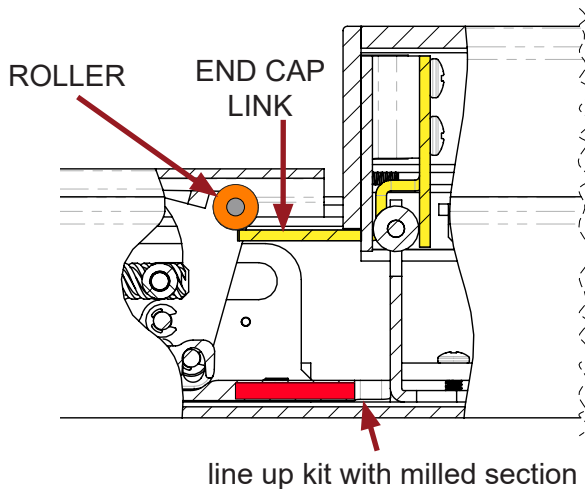

Tighten screws (4) securely.

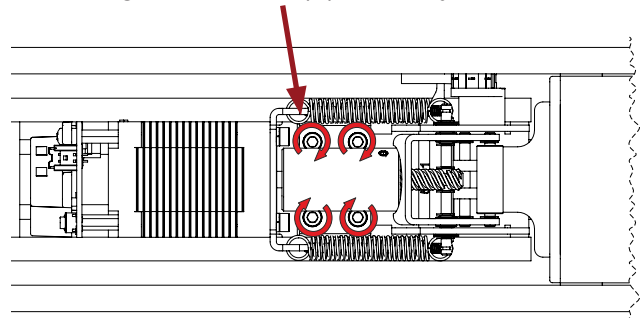

Test and adjust PTS

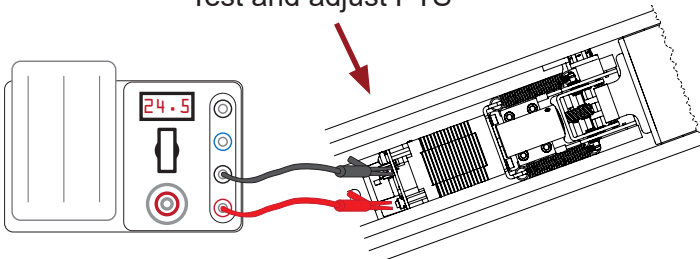

Re-install finishing pieces

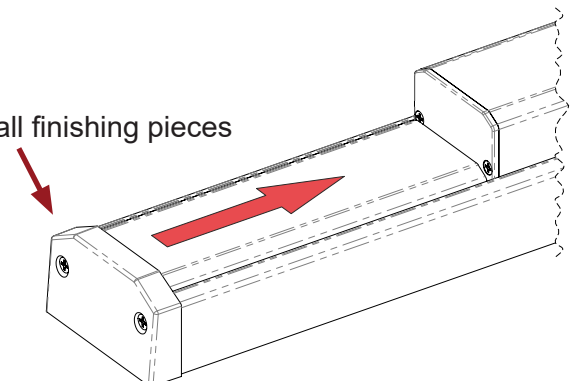

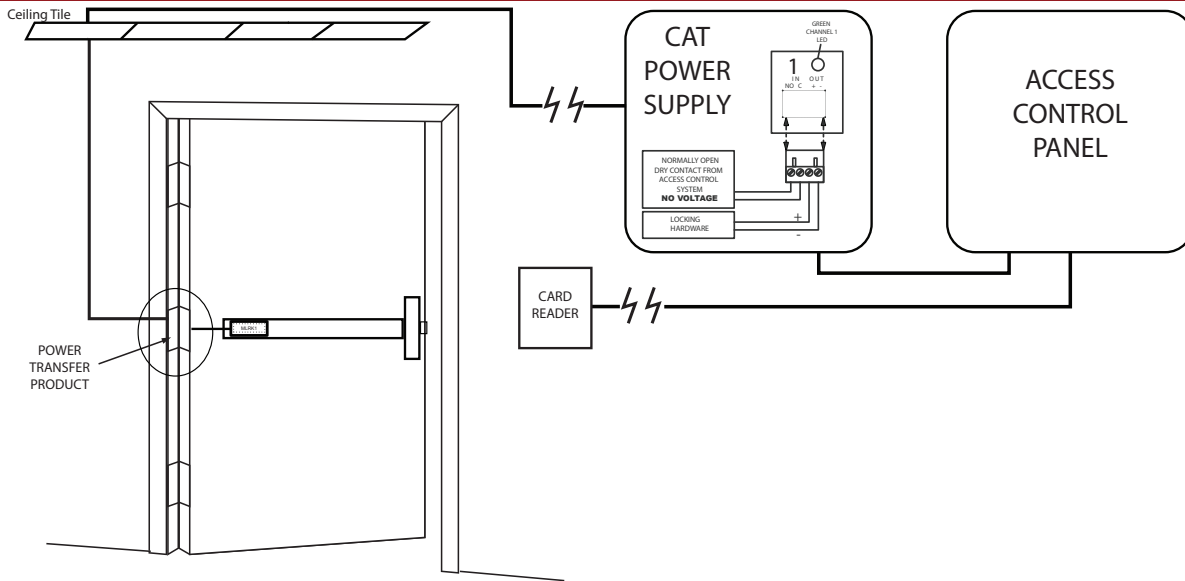

SETTING PUSH TO SET (PTS)

TO PUT THE DEVICE IN PTS MODE, FOLLOW THESE STEPS:

- Depress the MM5 button.
- Apply power and listen for short beep, which indicates that the device is now in PTS mode.
- Remove power.
- Release the button, but make sure you don't release it until the power is no longer going to the motor.

SET ADJUSTMENT:

- Depress the pushpad fully then release it 1/32", & hold.
- Apply power.
- Continue to hold the pushpad until the device gives you long beep.
- Remove power.

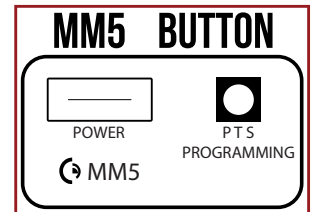

Note: Test the new location multiple times; if not to your liking, repeat the steps.

TROUBLESHOOTING & DIAGNOSTICS

BEEPS	EXPLANATION	SOLUTION
2 BEEPS (NO MOTOR SPIN)	OVER VOLTAGE	> 30V UNIT WILL SHUT DOWN. CHECK VOLTAGE & ADJUST TO 24 V.
3 BEEPS (NO MOTOR SPIN)	UNDER VOLTAGE	< 20V UNIT WILL SHUT DOWN. CHECK VOLTAGE & ADJUST TO 24 V.
4 BEEPS (NO MOTOR SPIN)	FAILED SENSOR	VERIFY ALL 3 SENSOR WIRES ARE INSTALLED CORRECTLY. REPLACE SENSOR IF PROBLEM PERSISTS BY CONTACTING OFFICE.
5 BEEPS MOTOR SPINS FOLLOWED BY 1-5 BEEPS	RETRACTION OR DOGGING FAILURE	<p>RESET PTS TO 95% OF FULL TRAVEL</p> <p>FOR HOLD OPEN CYCLES</p> <p>AFTER 1ST FAIL: 5 BEEPS THEN IMMEDIATELY ATTEMPTS TO RETRACT AGAIN.</p> <p>AFTER 2ND FAIL: 5 BEEPS WITH PAUSE IN-BETWEEN FOR 30 SECONDS THEN DEVICE ATTEMPTS TO RETRACT AGAIN.</p> <p>AFTER 3RD FAIL: 5 BEEPS EVERY 7 MINUTES, DEVICE WILL NOT ATTEMPT TO RETRACT. TO RESET DURING HOLD OPEN CYCLE, DEPRESS BAR FOR 5 SECONDS</p>